

**BYLAW 22-006
OF
LAC LA BICHE COUNTY**

A BYLAW OF LAC LA BICHE COUNTY IN THE PROVINCE OF ALBERTA FOR THE CANCELLATION OF PLAN OF SUBDIVISION.

WHEREAS section 658 of the *Municipal Government Act*, R.S.A. 2000, Chapter M-26 and amendments thereto, enable a Council, by bylaw, to order a subdivision plan cancelled, in whole or in part;

AND WHEREAS consent to cancel a plan of subdivision, certificate of title 212 188 409 (Lot 6, Block 1, Plan 1820858), to accommodate the consolidation of land with certificate of title 222 003 141 (Lot 2, Plan 0023713), has been given by the owners, and all persons shown on the certificate of title of the land in the plan of subdivision as having an estate or interest in it;

AND WHEREAS the owners of the certificate of title 212 188 409 (Lot 6, Block 1, Plan 1820858) and certificate of title 222 003 141 (Lot 2, Plan 0023713) have requested that the County cancel the plan of subdivision;

NOW THEREFORE under the authority and subject to the provisions of the *Municipal Government Act*, and by virtue of all other powers enabling it, the Council of Lac La Biche County, duly assembled, enacts as follows:

Cancellation of Plan of Subdivision

- 1 That the lands described in certificate of title 212 188 409 (Lot 6, Block 1, Plan 1820858) as shown on Schedule "A" in the amount of 0.809 hectares (2.0 acres), more or less, be cancelled from the plan of subdivision record.
- 2 That the cancelled subdivision plan be consolidated with certificate of title 222 003 141 (Lot 2, Plan 0023713).

Effective Date

- 3 This Bylaw shall come into effect upon passing of the third reading.

THAT BYLAW 22-006 BE GIVEN FIRST READING THIS 5th DAY OF APRIL, 2022.

THAT BYLAW 22-006 BE GIVEN SECOND READING THIS 5th DAY OF APRIL, 2022.

**THAT BYLAW 22-006 BE SUBMITTED FOR THIRD AND FINAL READING THIS 5th DAY OF APRIL, 2022.
2022.**

THAT BYLAW 22-006 BE GIVEN THIRD READING THIS 5th DAY OF APRIL, 2022.

"Original Signed"

Mayor

"Original Signed"

Chief Administrative Officer



SCHEDULE A

Bylaw No. 22-006

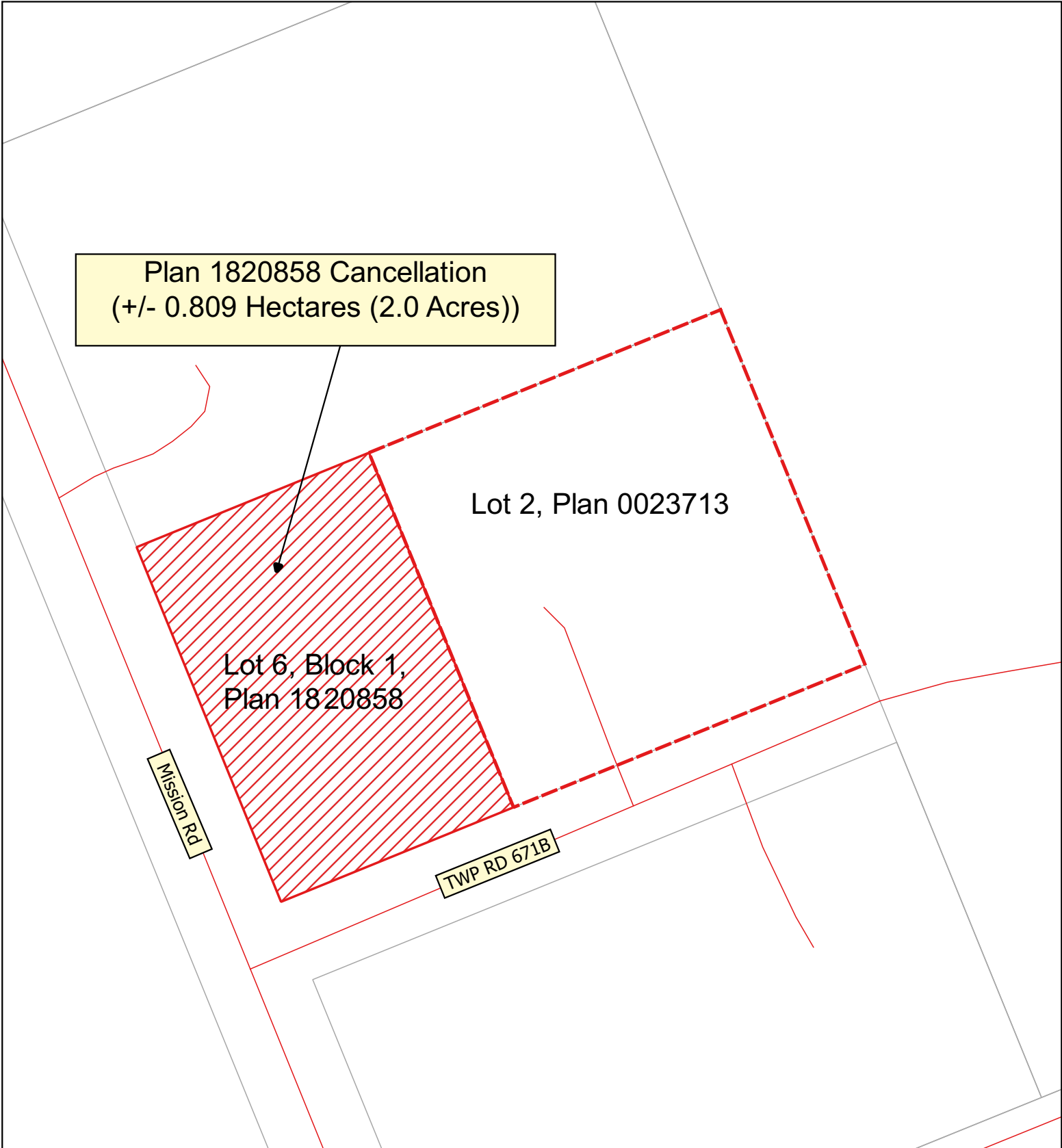

Map Produced: January 24, 2022

Projection: UTM12 NAD83



Lac La Biche County makes no representation or warranties regarding the information contained in this document, including, without limitation, whether said information is accurate or complete. Persons using this document do so solely at their own risk, and Lac La Biche County shall have no liability to such persons for any loss or damage whatsoever. This document shall not be copied or distributed to any person without the express written consent of Lac La Biche County.